



**HONGHUA AMERICA, LLC**

## HHF-2200 Mud Pump



**(832) 448.8100**

**[www.hh-america.com](http://www.hh-america.com)**



### HONGHUA Group ( HH) HHF series mud pump

is tough and field-proven, is specifically equipped to meet almost any customer requirement. We have provided more than 1000 sets in the world-wide. This is backed by our warranty and field support program.

HH group developed 2200HP (HHF2200) L series high pressure mud pump. The HHF2200 L high pressure mud pump is a kind of L series, triplex single-acting piston mud pump. HHF-2200 mud pump is made of high quality material and according to API 7K specification.

The HHF2200 L high pressure mud pump has two different structure of fluid end: piston structure and plunger structure. The plunger structure can provide higher pressure and bigger flow capacity.

## Specification

- **Rated input power** 2200HP (1641 KW)
- **Rated Stroke** 105 SPM
- **Max. liner Di a.** 9" ( 230 mm)
- **Rated Stroke distance** 14" ( 356 mm)
- **Gear Ratio:** 3.91: 1
- **Suction pipe size:** 12" (304.8mm), Flanged
- **Discharge pipe size:** API 5 1/8" Flanged, 10000psi
- **Max. discharge pressure** 7540 psi ( 52.0 MPa)
- **Max. discharge flow** 1231 gpm ( 77.65 L/s)
- **Valve chamber size:** API 8#
- **Lubrication:** Forced and splash
- **Discharge flow and pressure:** please reference table 1 and table 2





Technical parameter of Plunger structure

Table 1: Pressure parameter for mud pump HHF-2200 ( style 1: plunger structure)

Diameter of Liner	6 ¼"	6"	5 ½"	5"
Rated pressure (psi - MPa)	5700 psi 39.3 MPa	6485 psi 44.7 MPa	7445 psi 51.3 MPa	7500 psi 52.0 MPa

Table 2: Discharge parameter for mud pump HHF-2200 ( style 1: plunger structure)

Stroke (spm)	Rated power		Discharge capacity GPM			
	kW	HP	8"	7 ½"	7"	6 ½"
120	1874	2513	681	598	521	449
105*	1641	2200	596	524	456	393
100	1562	2095	567	499	434	374
90	1405	1884	511	449	391	337
80	1250	1676	454	399	347	300
70	1093	1466	397	349	304	262
1	-	-	5.673	4.986	4.343	3.745

Notes:

1. Calculated as per volumetric efficiency (100%) and mechanical efficiency (90%).
2. \* shows rated stroke numbers while operating.





Technical parameter of Piston structure

Table 1: Pressure parameter for mud pump HHF-2200 ( style 2: piston structure)

Diameter of Liner	9"	8 ¾"	8 ½"	8"	7 ½"	7"	6 ½"
Rated pressure (psi - MPa)	2760 psi 19.0 MPa	3015 psi 20.8 MPa	3310 psi 22.8 MPa	3650 psi 25.1 MPa	4040 psi 27.9 MPa	4500 psi 31.0 MPa	5050 psi 34.8 MPa

Table 2: Discharge parameter for mud pump HHF-2200 ( style 2: piston structure)

Stroke (spm)	Rated power		Discharge capacity GPM						
	kW	HP	9"	8 ¾"	8 ½"	8"	7 ½"	7"	6 ½"
120	1874	2513	1407	1287	1173	1064	960	862	768
105*	1641	2200	1231	1126	1026	931	840	754	672
100	1562	2095	1172	1072	977	886	800	718	640
90	1405	1884	1055	965	879	798	720	646	576
80	1250	1676	938	858	782	709	640	574	512
70	1093	1466	821	751	684	620	560	503	448
1	-	-	11.722	10.725	9.772	8.864	7.999	7.179	6.404

Notes:

1. Calculated as per volumetric efficiency (100%) and mechanical efficiency (90%).
2. \* shows rated stroke numbers while operating.





## Dimension

- **Transport dimension**

**Length**

**18'-10" ( 5740mm)**

**Width**

**9'- 2 ¼" (2505mm)**

**Height**

**7' – 10 ¾" (2405mm)**

- **Weight ( without damper)**

**93805 lbs (42550 kg)**

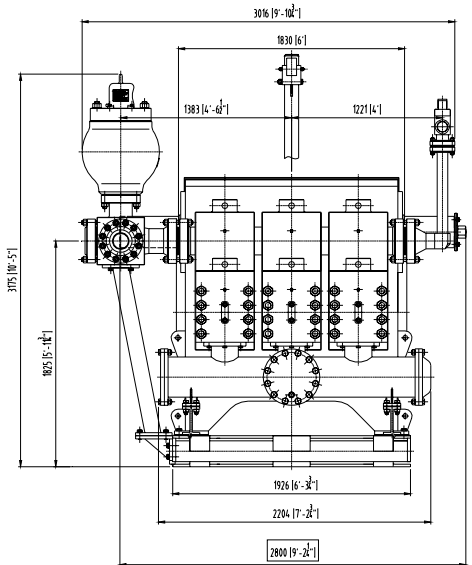
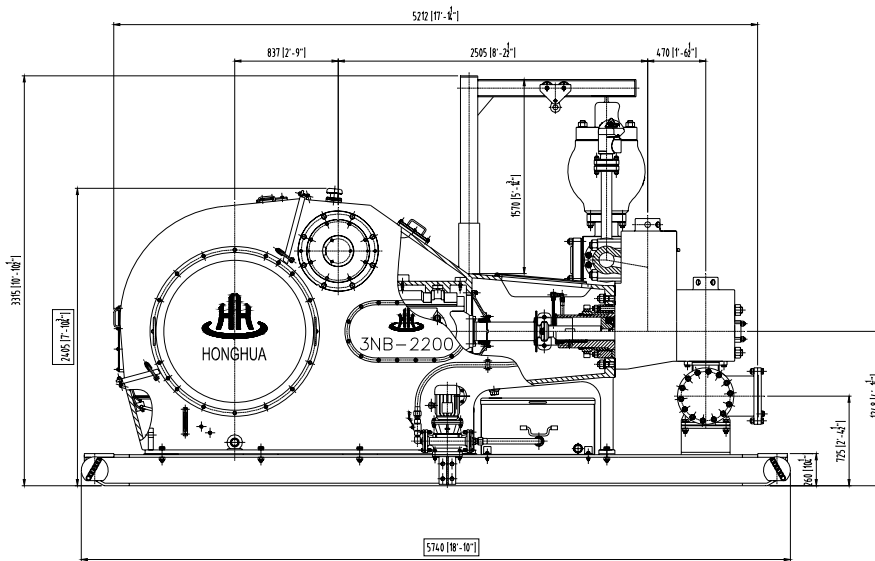



## Equipment scope

- Mud pump
- Damper and safety valve
- Equipped with Hoister.
- Completed with spare parts , special tools and fits



- We also maintain spare parts for you all requirements.

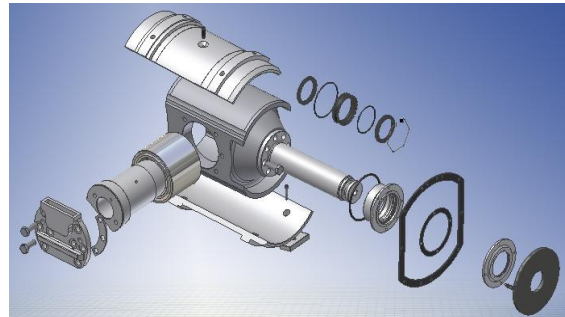
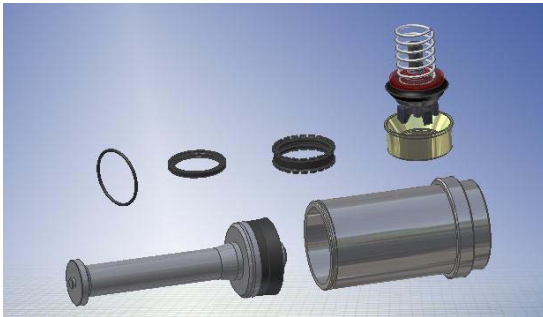

***Please contact us if you need more information!***

***Honghua, America, LLC***

***8300 McHard Road, Houston, TX 77053***

***Tel : (832) 448.8100***

***Fax : (832) 448.8101***

***E-mail: sales@hh-america.com***

***Website: www.hh-america.com***

