

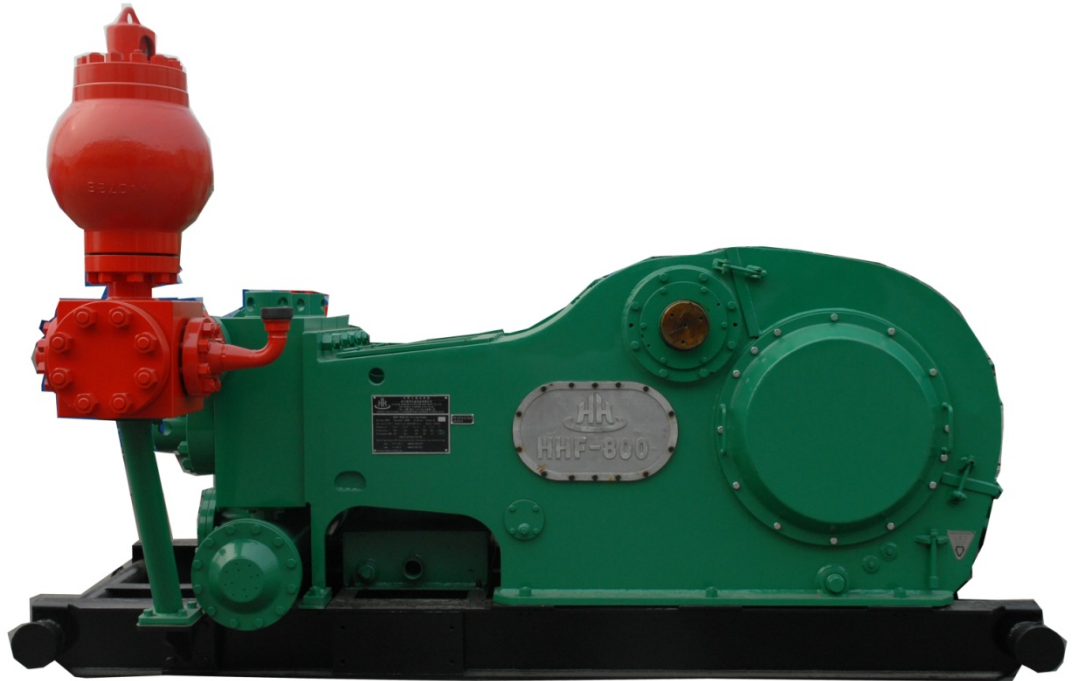

HONG HUA

HONGHUA AMERICA, LLC

HHF-800 Mud Pump



(832) 448.8100

www.hh-america.com



Mud Pump



HONGHUA Group (HH) HHF series mud pump is tough and field-proven, is specifically equipped to meet almost any customer requirement.

We have provided more than 1000 sets in the world-wide. This is backed by our warranty and field support program. And the HHF-800 pump is one of the most acceptable and developed mud pump.

HHF-800 mud pump is a kind of F series, triplex single-acting piston mud pump. HHF-800 mud pump is made of high quality material, according to API 7K specification.

Specification

- | | |
|--------------------------------|---|
| ▪ Rated input power | 800HP (746 KW) |
| ▪ Rated Stroke | 150SPM |
| ▪ Max. liner Di a. | 6 ¾" (170 mm) |
| ▪ Rated Stroke distance | 9" (229 mm) |
| ▪ Gear Ratio: | 4.185: 1 |
| ▪ Suction pipe size: | 10" (254 mm), Flanged |
| ▪ Discharge pipe size: | API 5 1/8" (130mm) Flanged, 5000psi |
| ▪ Valve chamber size: | API 6 # |
| ▪ Lubrication: | Forced and splash |
| ▪ Discharge flow and pressure: | please reference table 1 and table 2 |





Table 1: Pressure parameter for mud pump HHF- 800

Diameter of Liner	6 ¾”	6 ½”	6”	5 ½”	5 ”	4 ½”
Rated pressure (MPa-psi)	1969 psi 13.6 MPa	2122 psi 14.6 MPa	2490 psi 17.2 MPa	2962 psi 20.4 MPa	3588 psi 24.7 MPa	5000 psi 34.5 MPa

Table 2: Discharge parameter for mud pump HHF- 800

Stroke (spm)	Rated power		Discharge capacity GPM					
	kW	HP	6 ¾”	6 ½”	6”	5 ½”	5 ”	4 ½”
160	637	854	669	621	529	444	367	235
150*	597*	800*	627	582	496	417	344	220
140	557	747	586	543	463	389	321	206
130	518	694	544	504	430	361	298	191
120	477	640	502	465	397	333	275	176
110	438	587	460	427	364	305	252	162
100	397	533	418	388	330	278	229	147
1	-	-	4.18	3.88	3.30	2.78	2.29	1.47

Notes:

1. Calculated as per volumetric efficiency (100%) and mechanical efficiency (90%).
2. * shows rated stroke numbers while operating.





Dimension

- **Transport dimension**

Length

13' (3963mm)

Width

7'- ½" (2147mm)

Height

5' -7" (1700mm)

- **Weight (without damper)**

31970 lbs (14500 kg)

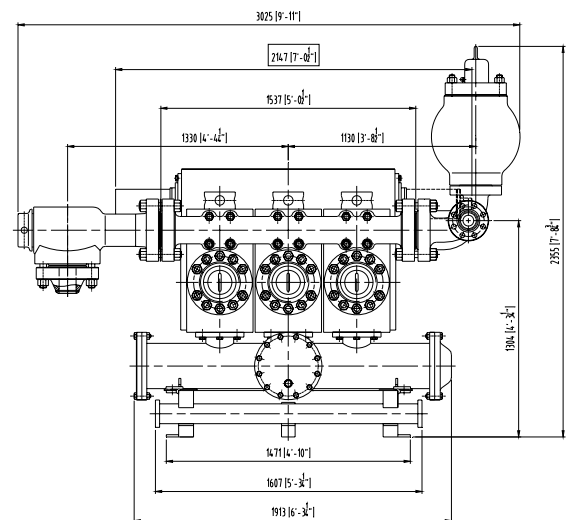
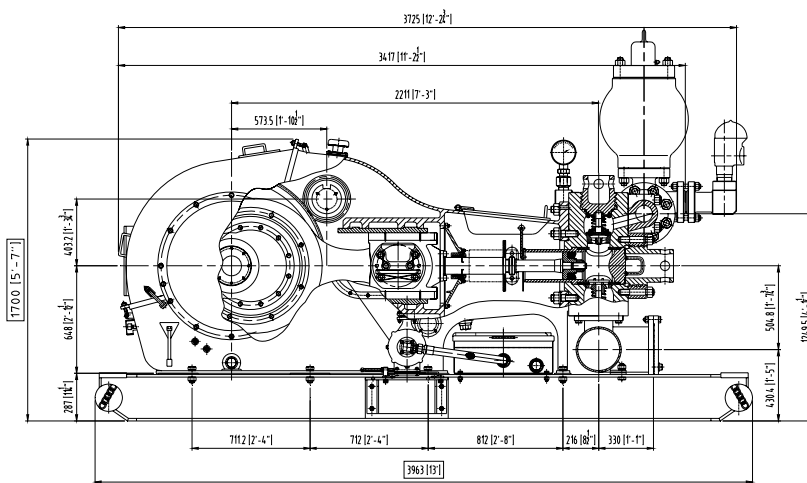



Equipment scope

- Mud pump with a liner
 - Damper and safety valve
 - Completed with spare parts and special tools and fits
-
- We also maintain spare parts for you all requirements.

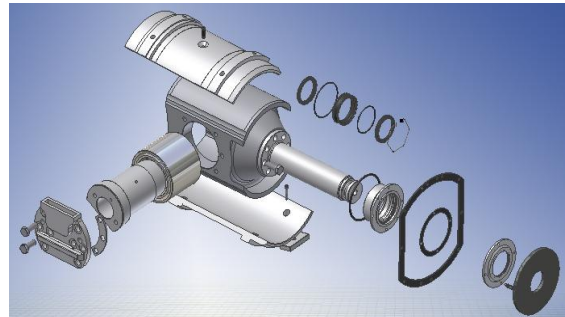
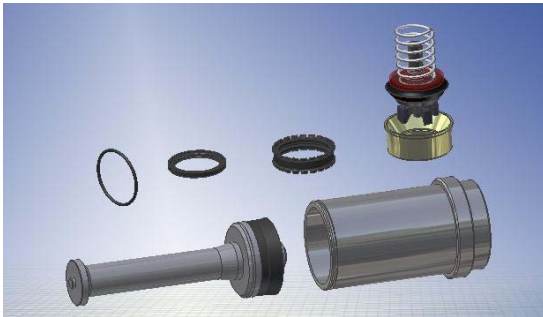

Please contact us if you need more information!

Honghua, America, LLC

8300 McHard Road, Houston, TX 77053

Tel : (832) 448.8100

Fax : (832) 448.8101

E-mail: sales@hh-america.com

Website: www.hh-america.com

